

OPERATING AND MAINTENANCE MANUAL

INTEGRATED FLOWMETER

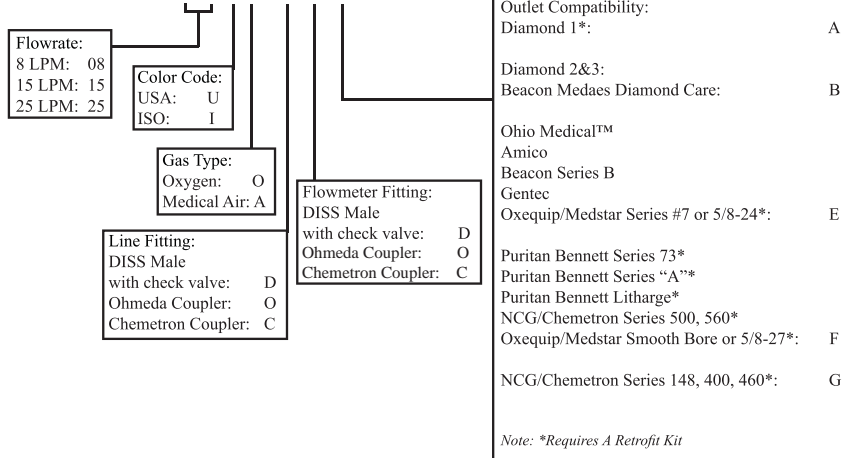

FI-CXYZ-WQ-S



CAUTION: Federal (USA) law restricts this device to sell by or on the order of a physician.



25B East Pearce St., Richmond Hill, ON L4B 2M9 Canada | Tel: 905-764-7736 | Fax: 905.764-7743 | www.amvex.com

1111 Lakeside Drive, Gurnee, IL 60031-4099
Tel: 1-800-448-0770 | Fax: 847-855-6300
www.ohiomedical.com

IMPORTANT: SAFETY INSTRUCTIONS

This manual is to provide you with information on the Integrated Flowmeter and to ensure the proper use and safety for this product.

READ AND UNDERSTAND ALL THE SAFETY AND OPERATING INSTRUCTIONS CONTAINED IN THIS BOOKLET.

IF YOU DO NOT UNDERSTAND THESE INSTRUCTIONS, OR HAVE ANY QUESTIONS, CONTACT YOUR SUPERVISOR, DEALER OR THE MANUFACTURER BEFORE ATTEMPTING TO USE THE APPARATUS.

⚠WARNING: Indicates a potentially hazardous situation, if not avoided, could result in death or serious injury.

ATTENTION: Indicates a potentially hazardous situation, if not avoided, could result in minor or moderate injury.

CAUTION: Indicates a potentially hazardous situation, which, if not avoided could result in property damage.

Receiving Inspection

Remove product from package and inspect for damage. Verify that the model received is in working order. If product is damaged, or incorrect do not use and contact your dealer, equipment provider or manufacturer.

ATTENTION: It is very important to allow product to remain in original packaging for 24 hours to acclimatize to room temperature before use.

ATTENTION: Store the product in a sealed package to avoid environmental damage. The operating and storage temperature for the Integrated Flowmeter should reflect typical environmental conditions of a medical facility environment.

User Responsibility

⚠WARNING: Service of this device should only be performed by properly trained individuals.

This product performs as explained in this manual. This holds true as long as the assembly, use, repair and maintenance are properly followed according to our instructions. Periodic review of this device is recommended. If any damage or defects are present, the product should not be used. This includes parts that may have been altered, contaminated, worn or missing. If any of the above are noted, immediate repair / replacement is required. In compliance with the Amvex Warranty, repair of this device is not to be performed by anyone other than an Amvex trained professional and done in strict accordance to the written instructions provided by Amvex. If this device is subject to improper maintenance, repair, use and or abuse leading to malfunction of the device, replacement is the sole responsibility of the user.

⚠WARNING: Operation of this device is not to be done if flammable anesthetics are present due to the possibility of explosion caused by static charge.

TO ELIMINATE THE RISK OF EXPLOSION OR FIRE:

- Only use lubricants recommended by Amvex Corporation.
- Never use grease, oil, organic lubricants or any flammable materials on or near the Integrated Flowmeter.
- Never smoke in an area where oxygen is being used.
- Never use any type of flame or flammable or explosive material near the Integrated Flowmeter.

⚠ WARNING: Never change the pin indexing, labeling, or any other gas specific component of the Integrated Flowmeter.

⚠ WARNING: The accuracy may be affected if the temperature of the gas is different than 70°F (21°C) and the supply pressure is different than that indicated on the faceplate.

ATTENTION: Do not disassemble the Integrated Flowmeter while the device is under pressure.

ATTENTION: Keep the Integrated Flowmeter in a clean area when not being used.

ATTENTION: Ensure that all connections are tightened and free of leaks prior to use. Use only an oxygen-safe leak detector when testing for leaks.

Intended Use

The Integrated Flowmeter has two ports, the Outlet port and the Flowmeter port. The Outlet port is intended to be used as a standard wall Outlet, delivering a high flow of gas to secondary equipment. The Flowmeter port is intended to deliver a fixed flow of gas to patient or equipment. The flow of gas is selectable via the control knob.

This manual and all other labels and inserts are strictly for the ease of operators that have proper tools and knowledge in the repair of this device, and properly trained Amvex representatives. DO NOT change, alter or modify intended use of the product.

Specifications

GAS	SCALE	ACCURACY	MAX FLOOD
OXYGEN OR MEDICAL AIR	0-8 LPM	+/- .15 LPM FROM 0.5 TO 1 LPM +/- 10% OF INDICATED FLOW FOR 2LPM AND ABOVE	N/A
OXYGEN OR MEDICAL AIR	0-15 LPM	+/- .15 LPM FROM 0.5 TO 1 LPM +/- 10% OF INDICATED FLOW FOR 2LPM AND ABOVE	20-30 LPM
OXYGEN OR MEDICAL AIR	0-25 LPM	+/- .15 LPM FROM 0.5 TO 1 LPM +/- 10% OF INDICATED FLOW FOR 2LPM AND ABOVE	N/A

Installation Instructions

1. Remove Integrated Flowmeter from packaging.
2. Remove all plugs from port fittings and brass barrel.
3. Make sure the zone valve for the outlet receptacle is closed and line depressurized.
4. Insert brass barrel of the Integrated Flowmeter into the outlet receptacle.
5. Secure the Integrated Flowmeter into place by screwing in both fastening screws located on the faceplate.

Flowmeter Operating Instructions

1. Inspect the Integrated Flowmeter for damage; if any is found do not use the unit.
2. The Flowmeter is associated with the right hand port and labeled with the word "Flowmeter".
3. Turn the Flow Control Knob counter clockwise to increase flow or clockwise to decrease flow. Flow rates are indicated in liters per minute.

NOTE: The Flow Control Knob will not allow the user to move directly from the zero position to the highest flow rate.

4. The Flowmeter is in the off position when the Flow Control Knob is on the "0" setting.
5. The Flowmeter Port can be fitted with accessories with a mating DISS connection such as a hose assembly, tubing nipple or humidifier.

NOTE: The flow rate may be affected by a change in downstream resistance of the Flowmeter Port.

6. The Flow Indicator Window will have a ball showing when there is flow to the patient, and the Flow Indicator Window will be empty when there is no flow.
7. When the Flowmeter is not in use return the Flow Control Knob to the "0" position.

Cleaning Instructions

Wipe outside of product with a clean dampened cloth with a mild cleaning solution. DO NOT gas sterilize with ETO. DO NOT clean with pungent hydrocarbons.

CAUTION: DO NOT submerge Integrated Flowmeter in any form of liquid. This will cause damage and void any warranty on the product.

Troubleshooting

Contact your dealer or the technical support department at Amvex Corporation for assistance if the Integrated Flowmeter does not function.

Maintenance Prevention

Inspect the product before and after use for any damage and ease of operation.



WARNING: When changing connectors on the Integrated Flowmeter for service or replacement, never re-attach connectors of a different gas. Doing so may result in a patient injury or damage to the equipment.

ATTENTION: Do not disassemble the Integrated Flowmeter while the device is under pressure.

Spare Parts

FI-ALU-KNB	Aluminum Knob
FI-IFM-ELB	Flowmeter Port Elbow
FI-OXY-NPL	Oxygen Tubing Nipple
FI-AIR-NPL	Medical Air Tubing Nipple
FI-ORG-KIT	Oring Replacement Kit

Labeled Assembly

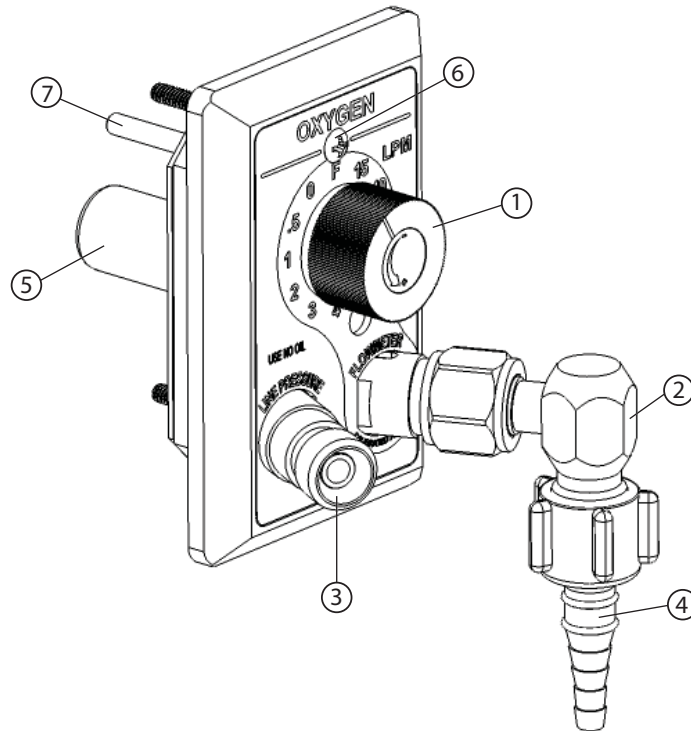

- ① Flow Control Knob
- ② Flowmeter Port
- ③ Outlet Port
- ④ Tubing Nipple
- ⑤ Brass Barrel
- ⑥ Fastening Screws
- ⑦ Index Pin

WARRANTY

Amvex Corporation warrants its Medical Secondary Equipment to be free from defects in material and workmanship for a period of Five (5) years from the date of shipment. Within the first Twelve (12) months from date of shipment Amvex will repair or replace any part which is proven to be defective at Amvex's cost. After the first Twelve (12) months, Amvex will send the parts to the customer free of charge, but the shipping and installation will be borne by the Customer. This warranty is valid only when the product has been properly installed according to Amvex specifications, used in a normal manner and serviced according to factory recommendations. It does not cover failures due to damage which occurs in shipments or failures which resulted from accidents, misuse, abuse, neglect, mishandling, alteration, misapplication or damage that may be attributable to acts of God.

AMVEX CORPORATION DOES NOT HONOR VERBAL STATEMENTS CONCERNING THE WARRANTY.

The distributor and/or dealer is not sanctioned to create verbal warranties about the product described in this agreement. Any statements will not be honored or be made part of the agreement of sale. This document is the final, complete and exclusive terms of the agreement.

THIS WARRANTY IS INCLUSIVE AND REPLACES ALL OTHER WARRANTIES.

Amvex Corporation shall not, under any circumstances, be liable for incidental or consequential damages including, but not limited to, profit loss, loss of sales or injuries to person(s) or property. Correction of non-compliances as noted above will result in completion of all liabilities of Amvex Corporation whether based on agreement, neglect or otherwise.

Amvex Corporation reserves the right to stop manufacturing any product or change materials, designs or specifications without notice. All claims for warranty must first be approved by Amvex's Service Department: (support@amvex.com or 905-764-7736 Toll Free: 1-866-462-6839). A valid Return Goods Authorization (RGA) number must be obtained from Amvex prior to commencement of any warranty claim.